

FICHE D'HOMOLOGATION / HOMOLOGATION FORM



047-TM-69



COMMISSION
INTERNATIONALE
DE KARTING - FIA

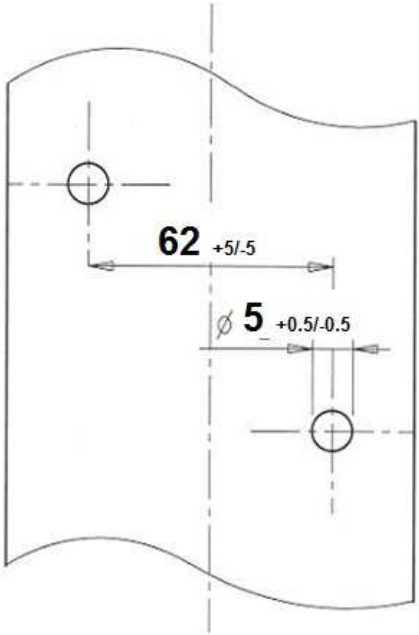

PNEUMATIQUE / TYRE 5" SLICK MINI / WET MINI

Constructeur / Manufacturer	VEGA S.r.l.
Marque / Make	VEGA
Modèle / Model	M1 CIK MINI 11X5.00-5
Catégorie / Category	GROUPE 3 / GROUP 3
Durée de l'homologation / Validity of the Homologation	3 ans / 3 years
Nombre de pages / Number of pages	4
La présente Fiche d'Homologation reproduit descriptions, illustrations et dimensions du pneumatique au moment de l'homologation CIK-FIA et du test d'homologation.	<i>This Homologation Form reproduces descriptions, illustrations and dimensions of the tyre at the moment of the CIK-FIA homologation and of the homologation test.</i>
	
Photo du pneu monté sur la jante / Photo of the tyre fitted to the rim	Dessin de la bande de roulement / Tread design drawing
SIGNATURE ET TAMPON DE L'ASN SIGNATURE AND STAMP OF THE ASN	SIGNATURE ET TAMPON DE LA CIK-FIA SIGNATURE AND STAMP OF THE CIK-FIA
	

DESCRIPTIONS TECHNIQUES	TECHNICAL DESCRIPTIONS
Sous une température de 23°C +/-2°C, avec une humidité de 50% +/-5%	At a temperature of 23°C +/-2°C and with a humidity of 50% +/-5%

Pt	Descriptions / Descriptions	Valeurs / Value		Tolérances / Tolerances	
1	Dimensions / Dimensions	11x5.00-5		--	
2	Désignation du mélange / Tread compound designation	M1		--	
3	Pression de service / Service pressure	1 bar		+/- 0.3 bar	
4	Pression de gonflage / Inflation pressure	4 bar		max	
5	Capacité de charge / Load capacity	100 kg		max	
6	Vitesse maximale / Maximum speed	160 km/h			
7	Rigidité latérale et verticale (sous charge de 40 kg) / Lateral and vertical stiffness (under 40 kg load)	L = 1, V = 14 mm		L: +/-1 V: +/-2	
8					
9	Profondeur du profil / Depth of tread	3.8 mm		+/- 0.5 mm	
10	Poids en grammes / Weight in grams	1300gr		+/- 10%	
11	Nombre de plis / Numbers of plies	2		--	
12	Épaisseur de la bande de roulement / Tread thickness	4.5 mm		+/- 1.0 mm	
13	Nombre d'indicateurs d'usure du pneu / Number of tread wear indicators	6		--	
14	Matériau de la carcasse / Carcass material	POLYESTER		--	
15	Angle de tissage de la toile du pneu / Angle of tyre canvas	34		+/- 3°	
16	Type de fil de tissage (selon ISO) / Canvas thread type (according to ISO)	1100		--	
17	Pneu tubeless / Tubeless tyre	YES		--	
18	Dureté superficielle de la bande de roulement (ISO 48:1010 – 2 échantillons de 2 mm d'épaisseur) / Superficial tread hardness (ISO 48:1010 – 2 samples of 2 mm thickness)			+/- 5 DIDC - IRHD	
19	Contrainte-déformation en traction (ISO 37:2017 – éprouvette type 3) / Tensile stress-strain (ISO 37:2017 – type 3 sample)	à / at 100%	à / at 300%	à / at 100%	à / at 300%
				+/- 0.5 MPa	+/- 0.8 MPa
20	Largeur de la bande / Tread width			Avant/Front : max. 80 mm / Arrière/Rear : max. 120 mm	

DESSIN	DRAWING
--------	---------

Dessin du pneu en section transversale et dimensions du pneu monté sur une jante / Drawing of tyre cross section and dimensions of the tyre fitted to a rim	Dimensions / Dimensions	Tolérances / Tolerances
	mm	+/- X mm
	Ø 126.2 *	+0/-1.0
	Ø 265 mm	+/- 5
	145 mm	+/- 5
	105 mm	+/- 5
	135 mm	+/- 5
<p>*Dimension selon Dessin Technique N° 4 jante 5" standardisée / Dimension according to Technical Drawing N° 4 standardised 5" rim</p>		

DESSIN TECHNIQUE N°4

Jante 5"

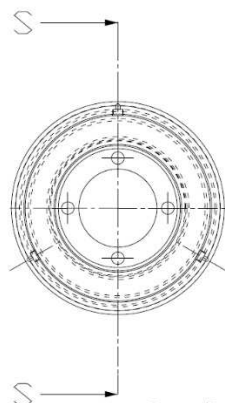

Cotes en/Dimensions in mm

TECHNICAL DRAWING No. 4

5" Rim

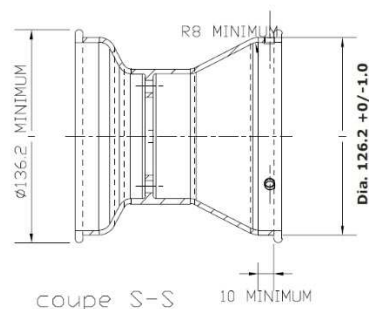

coupe S-S



PHOTOS ET INSCRIPTIONS	PHOTOS AND INSCRIPTIONS																																						
Seules les inscriptions sur le flanc extérieur du pneu qui ne changeront pas tout au long de la fabrication sont reportées ci-dessous.	<i>Only the inscriptions on the tyre external sidewall that will remain unchanged during production are mentioned below.</i>																																						
Photo du flanc extérieur du pneu / <i>Photo of tyre external sidewall</i>	Inscription sur le flanc extérieur du pneu / <i>Inscriptions on tyre external sidewall</i>																																						
	<table border="1"> <thead> <tr> <th data-bbox="799 730 1141 792">Texte / Text</th> <th data-bbox="1144 730 1310 792">Hauteur / Height</th> <th data-bbox="1313 730 1481 792">Trait / Stroke</th> </tr> </thead> <tbody> <tr> <td data-bbox="799 797 1141 837">VEGA (printed)</td> <td data-bbox="1144 797 1310 837"></td> <td data-bbox="1313 797 1481 837"></td> </tr> <tr> <td data-bbox="799 842 1141 882">KART >></td> <td data-bbox="1144 842 1310 882">9.5 mm</td> <td data-bbox="1313 842 1481 882">2.8/4 mm</td> </tr> <tr> <td data-bbox="799 887 1141 927">11 x 5.00 – 5</td> <td data-bbox="1144 887 1310 927">6.5 mm</td> <td data-bbox="1313 887 1481 927">3 mm</td> </tr> <tr> <td data-bbox="799 931 1141 1016">Max inflation pressure 4 bar</td> <td data-bbox="1144 931 1310 1016">3.8 mm</td> <td data-bbox="1313 931 1481 1016">1 mm</td> </tr> <tr> <td data-bbox="799 1021 1141 1061">Barcode (printed)</td> <td data-bbox="1144 1021 1310 1061"></td> <td data-bbox="1313 1021 1481 1061"></td> </tr> <tr> <td data-bbox="799 1066 1141 1106"></td> <td data-bbox="1144 1066 1310 1106"></td> <td data-bbox="1313 1066 1481 1106"></td> </tr> <tr> <td data-bbox="799 1111 1141 1151"></td> <td data-bbox="1144 1111 1310 1151"></td> <td data-bbox="1313 1111 1481 1151"></td> </tr> <tr> <td data-bbox="799 1155 1141 1196"></td> <td data-bbox="1144 1155 1310 1196"></td> <td data-bbox="1313 1155 1481 1196"></td> </tr> <tr> <td data-bbox="799 1200 1141 1240"></td> <td data-bbox="1144 1200 1310 1240"></td> <td data-bbox="1313 1200 1481 1240"></td> </tr> <tr> <td data-bbox="799 1245 1141 1285"></td> <td data-bbox="1144 1245 1310 1285"></td> <td data-bbox="1313 1245 1481 1285"></td> </tr> <tr> <td data-bbox="799 1290 1141 1330"></td> <td data-bbox="1144 1290 1310 1330"></td> <td data-bbox="1313 1290 1481 1330"></td> </tr> </tbody> </table>	Texte / Text	Hauteur / Height	Trait / Stroke	VEGA (printed)			KART >>	9.5 mm	2.8/4 mm	11 x 5.00 – 5	6.5 mm	3 mm	Max inflation pressure 4 bar	3.8 mm	1 mm	Barcode (printed)																						
	Texte / Text	Hauteur / Height	Trait / Stroke																																				
	VEGA (printed)																																						
	KART >>	9.5 mm	2.8/4 mm																																				
	11 x 5.00 – 5	6.5 mm	3 mm																																				
	Max inflation pressure 4 bar	3.8 mm	1 mm																																				
	Barcode (printed)																																						
	9.5 mm	2.8/4 mm																																					
	6.5 mm	3 mm																																					
	3.8 mm	1 mm																																					

Photo du flanc intérieur du pneu / <i>Photo of tyre internal sidewall</i>	Inscription sur le flanc intérieur du pneu / <i>Inscriptions on tyre internal sidewall</i>																																				
	<table border="1"> <thead> <tr> <th data-bbox="799 1480 1141 1543">Texte / Text</th> <th data-bbox="1144 1480 1310 1543">Hauteur / Height</th> <th data-bbox="1313 1480 1481 1543">Trait / Stroke</th> </tr> </thead> <tbody> <tr> <td data-bbox="799 1547 1141 1588">VEGA</td> <td data-bbox="1144 1547 1310 1588">13 mm</td> <td data-bbox="1313 1547 1481 1588">3/8 mm</td> </tr> <tr> <td data-bbox="799 1592 1141 1632">11 x 5.00 – 5</td> <td data-bbox="1144 1592 1310 1632">6.5 mm</td> <td data-bbox="1313 1592 1481 1632">3 mm</td> </tr> <tr> <td data-bbox="799 1637 1141 1677">Made in Italy</td> <td data-bbox="1144 1637 1310 1677">3.8 mm</td> <td data-bbox="1313 1637 1481 1677">1 mm</td> </tr> <tr> <td data-bbox="799 1682 1141 1722">Tubless</td> <td data-bbox="1144 1682 1310 1722">3.8 mm</td> <td data-bbox="1313 1682 1481 1722">1 mm</td> </tr> <tr> <td data-bbox="799 1727 1141 1812">For racing purpose only</td> <td data-bbox="1144 1727 1310 1812">3.8 mm</td> <td data-bbox="1313 1727 1481 1812">1 mm</td> </tr> <tr> <td data-bbox="799 1816 1141 1856">M1</td> <td data-bbox="1144 1816 1310 1856">9.5 mm</td> <td data-bbox="1313 1816 1481 1856">3.7 mm</td> </tr> <tr> <td data-bbox="799 1861 1141 1901">CIK Mini</td> <td data-bbox="1144 1861 1310 1901">5 mm</td> <td data-bbox="1313 1861 1481 1901">2 mm</td> </tr> <tr> <td data-bbox="799 1906 1141 1946">Barcode (printed)</td> <td data-bbox="1144 1906 1310 1946"></td> <td data-bbox="1313 1906 1481 1946"></td> </tr> <tr> <td data-bbox="799 1951 1141 1991"></td> <td data-bbox="1144 1951 1310 1991"></td> <td data-bbox="1313 1951 1481 1991"></td> </tr> <tr> <td data-bbox="799 1995 1141 2036"></td> <td data-bbox="1144 1995 1310 2036"></td> <td data-bbox="1313 1995 1481 2036"></td> </tr> </tbody> </table>	Texte / Text	Hauteur / Height	Trait / Stroke	VEGA	13 mm	3/8 mm	11 x 5.00 – 5	6.5 mm	3 mm	Made in Italy	3.8 mm	1 mm	Tubless	3.8 mm	1 mm	For racing purpose only	3.8 mm	1 mm	M1	9.5 mm	3.7 mm	CIK Mini	5 mm	2 mm	Barcode (printed)											
	Texte / Text	Hauteur / Height	Trait / Stroke																																		
	VEGA	13 mm	3/8 mm																																		
	11 x 5.00 – 5	6.5 mm	3 mm																																		
	Made in Italy	3.8 mm	1 mm																																		
	Tubless	3.8 mm	1 mm																																		
	For racing purpose only	3.8 mm	1 mm																																		
	M1	9.5 mm	3.7 mm																																		
	CIK Mini	5 mm	2 mm																																		
	Barcode (printed)																																				
	13 mm	3/8 mm																																			
	6.5 mm	3 mm																																			
	3.8 mm	1 mm																																			
	3.8 mm	1 mm																																			
	3.8 mm	1 mm																																			
	9.5 mm	3.7 mm																																			
	5 mm	2 mm																																			